

P-Channel 200-V (D-S) MOSFET

Key Features:

- Low $r_{DS(on)}$ trench technology
- Low thermal impedance
- Fast switching speed

Typical Applications:

- PoE Power Sourcing Equipment
- PoE Powered Devices
- Telecom DC/DC converters
- White LED boost converters



RoHS
COMPLIANT
HALOGEN
FREE

SOT-23

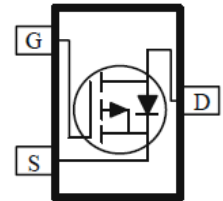
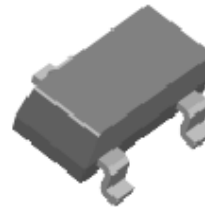

PRODUCT SUMMARY		
V_{DS} (V)	$r_{DS(on)}$ (Ω)	I_D (A)
-200	2.5 @ $V_{GS} = -10V$	-0.6
	2.8 @ $V_{GS} = -5.5V$	-0.5

ABSOLUTE MAXIMUM RATINGS ($T_A = 25^\circ\text{C}$ UNLESS OTHERWISE NOTED)				
Parameter		Symbol	Limit	Units
Drain-Source Voltage		V_{DS}	-200	V
Gate-Source Voltage		V_{GS}	± 20	
Continuous Drain Current ^a	$T_A = 25^\circ\text{C}$	I_D	-0.6	A
	$T_A = 70^\circ\text{C}$		-0.5	
Pulsed Drain Current ^b		I_{DM}	5	
Continuous Source Current (Diode Conduction) ^a		I_S	1.2	A
Power Dissipation ^a	$T_A = 25^\circ\text{C}$	P_D	1.3	W
	$T_A = 70^\circ\text{C}$		0.8	
Operating Junction and Storage Temperature Range		T_J, T_{stg}	-55 to 150	$^\circ\text{C}$

THERMAL RESISTANCE RATINGS				
Parameter		Symbol	Maximum	Units
Maximum Junction-to-Ambient ^a	$t \leq 10 \text{ sec}$	$R_{\theta JA}$	100	$^\circ\text{C/W}$
	Steady State		166	

Notes

- Surface Mounted on 1" x 1" FR4 Board.
- Pulse width limited by maximum junction temperature

Parameter	Symbol	Test Conditions	Min	Typ	Max	Unit
Static						
Gate-Source Threshold Voltage	$V_{GS(th)}$	$V_{DS} = V_{GS}, I_D = -250 \mu A$	-1			V
Gate-Body Leakage	I_{GSS}	$V_{DS} = 0 V, V_{GS} = \pm 20 V$			± 100	nA
Zero Gate Voltage Drain Current	I_{DSS}	$V_{DS} = -160 V, V_{GS} = 0 V$			-1	μA
		$V_{DS} = -160 V, V_{GS} = 0 V, T_J = 55^\circ C$			-10	
On-State Drain Current	$I_{D(on)}$	$V_{DS} = -5 V, V_{GS} = -10 V$	-0.5			A
Drain-Source On-Resistance	$r_{DS(on)}$	$V_{GS} = -10 V, I_D = -0.5 A$			2.5	Ω
		$V_{GS} = -5.5 V, I_D = -0.4 A$			2.8	
Forward Transconductance	g_{fs}	$V_{DS} = -15 V, I_D = -0.5 A$		1.8		S
Diode Forward Voltage	V_{SD}	$I_S = -0.6 A, V_{GS} = 0 V$		-0.87		V
Dynamic						
Total Gate Charge	Q_g	$V_{DS} = -100 V, V_{GS} = -5.5 V,$ $I_D = -0.5 A$		3.7		nC
Gate-Source Charge	Q_{gs}			1.1		
Gate-Drain Charge	Q_{gd}			1.5		
Turn-On Delay Time	$t_{d(on)}$	$V_{DD} = -100 V, R_L = 200 \Omega,$ $I_D = -0.5 A,$ $V_{GEN} = -10 V, R_{GEN} = 6 \Omega$		4		ns
Rise Time	t_r			10		
Turn-Off Delay Time	$t_{d(off)}$			13		
Fall-Time	t_f			10		
Input Capacitance	C_{iss}	$V_{DS} = -15 V, V_{GS} = 0 V, f = 1 MHz$		301		pF
Output Capacitance	C_{oss}			39		
Reverse Transfer Capacitance	C_{rss}			21		

Notes

- Pulse test: PW $\leq 300 \mu s$ duty cycle $\leq 2\%$.
- Guaranteed by design, not subject to production testing.

Typical Electrical Characteristics

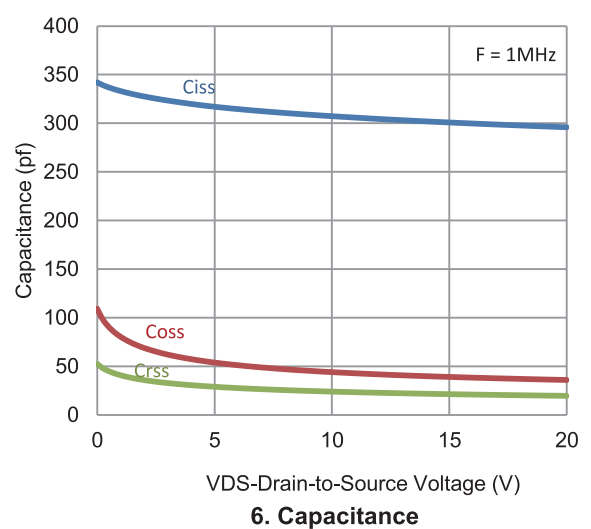
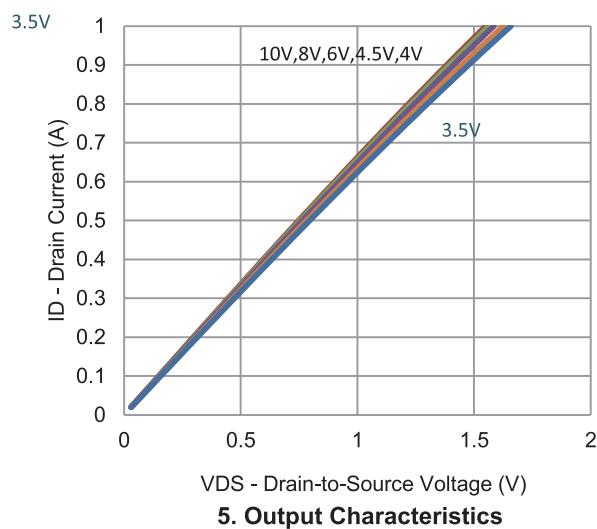
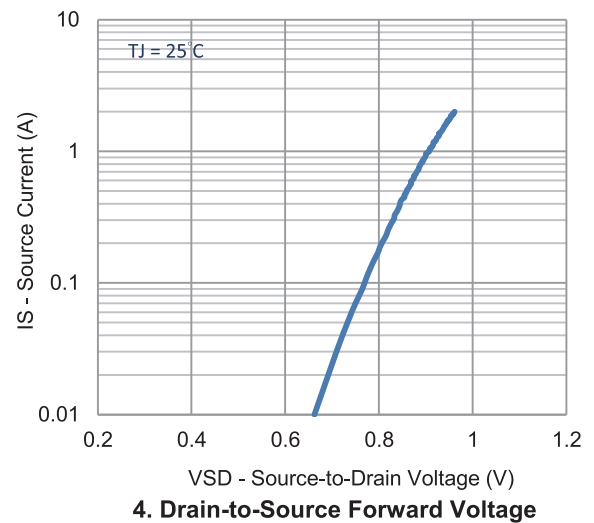
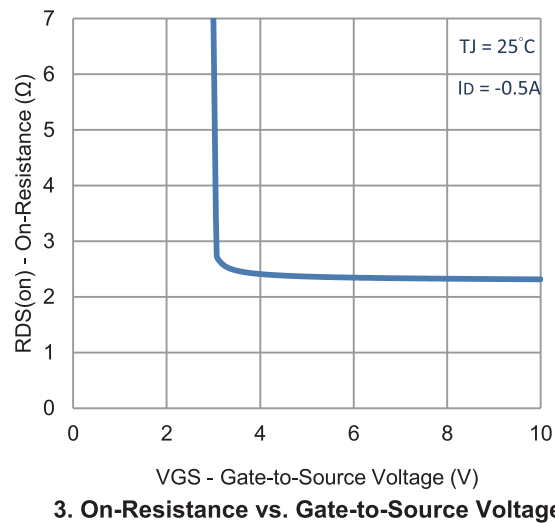
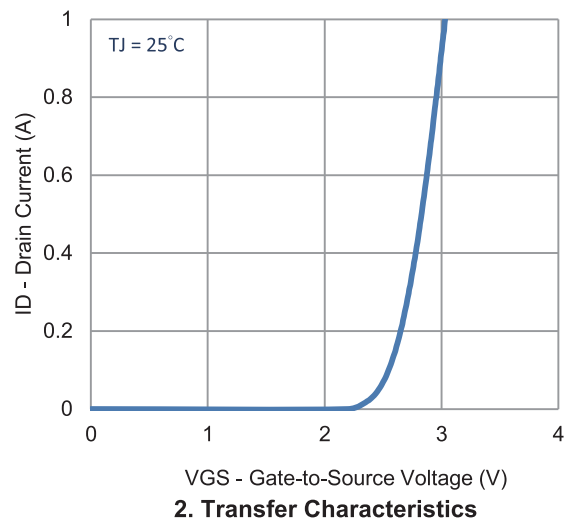
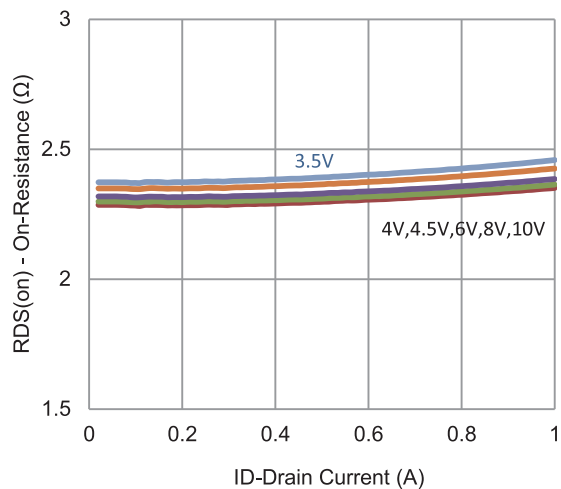

Typical Electrical Characteristics

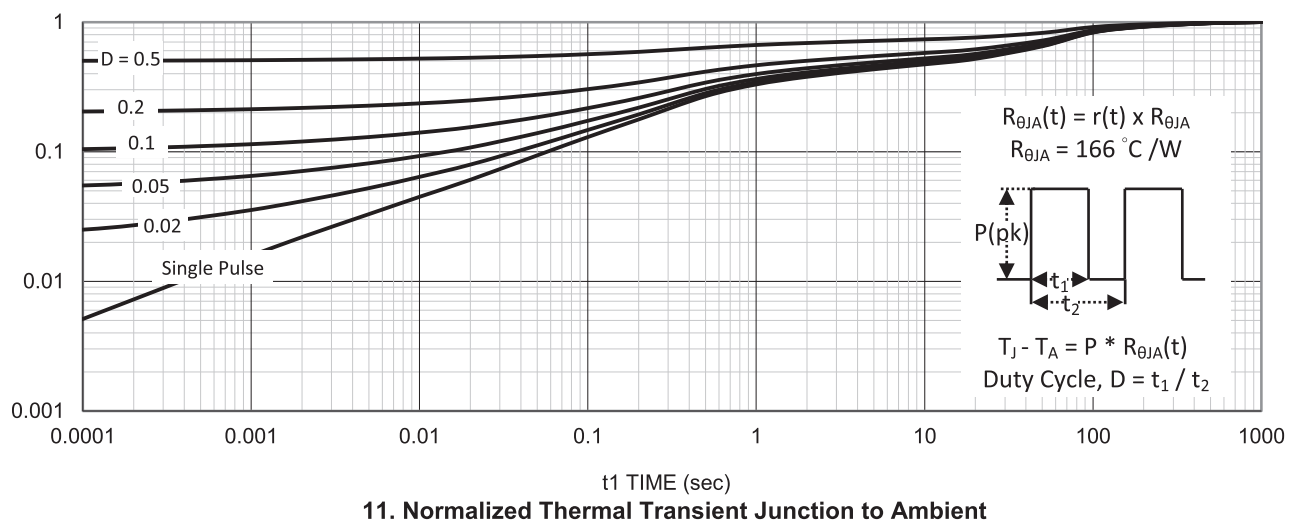
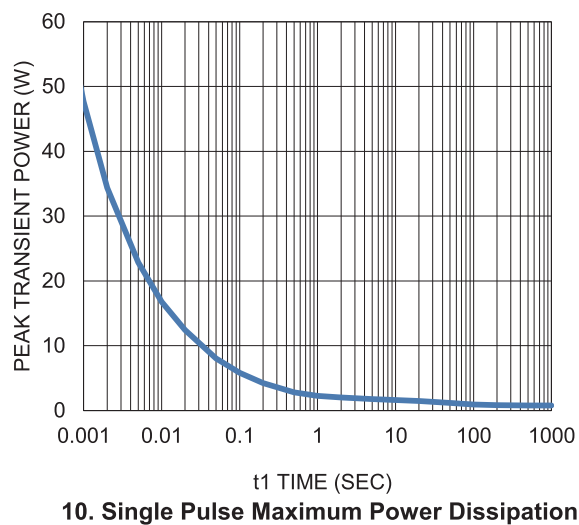
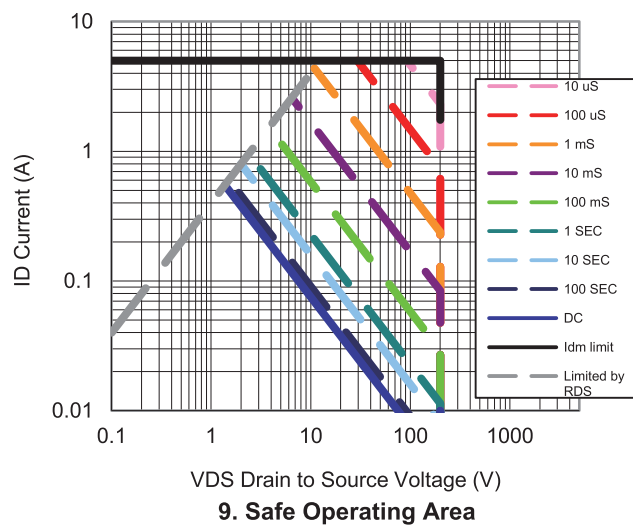
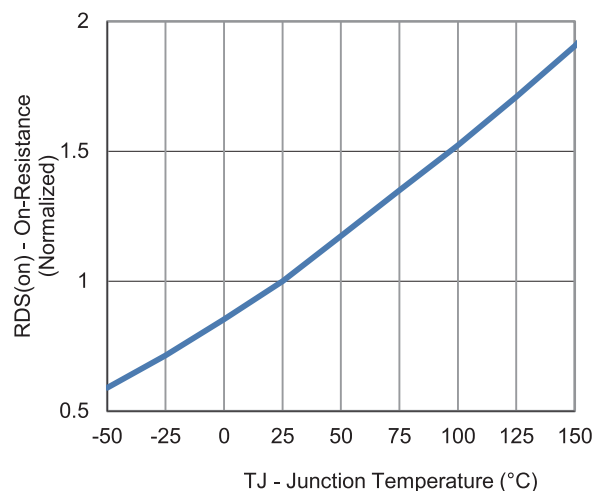
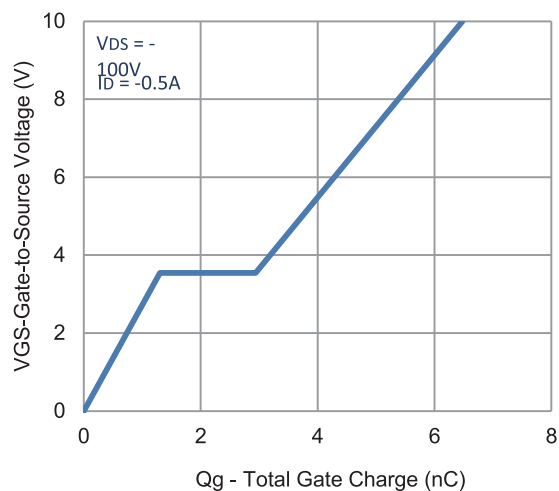

Package Information

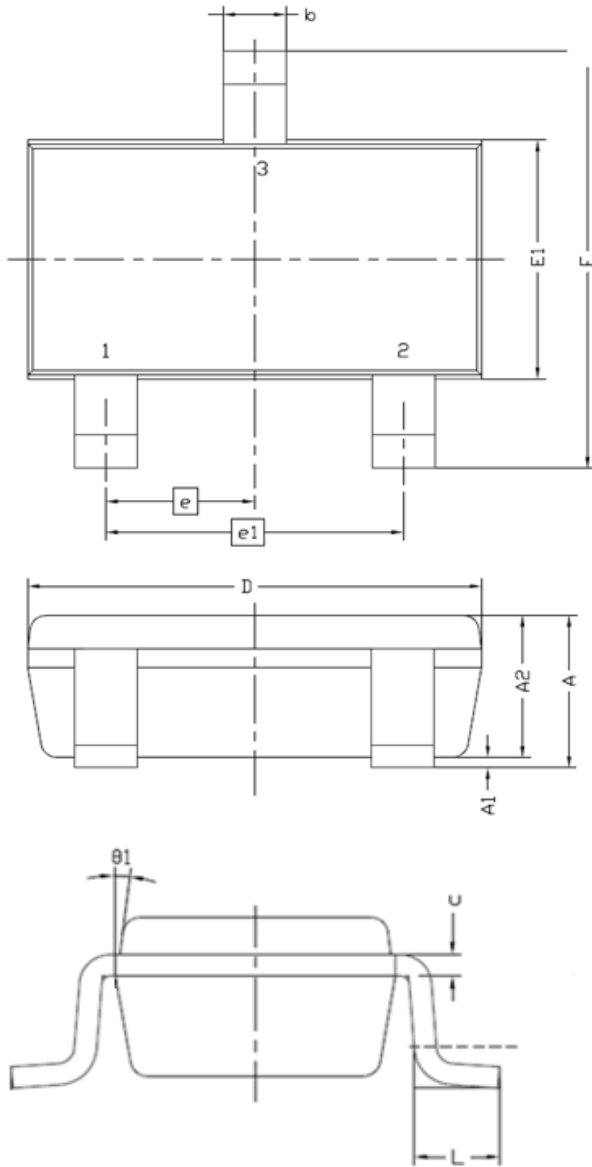

Symbol	MILLIMETERS	
	MIN	MAX
A	0.8	1.2
A1	0	0.1
A2	0.7	1.1
b	0.3	0.5
c	0.1	0.2
D	2.7	3.1
E	2.6	3
E1	1.4	1.8
e	0.95 BSC	
e1	1.9 BSC	
L	0.3	0.6
θ1	7° NOM	

Recommended Pad Layout

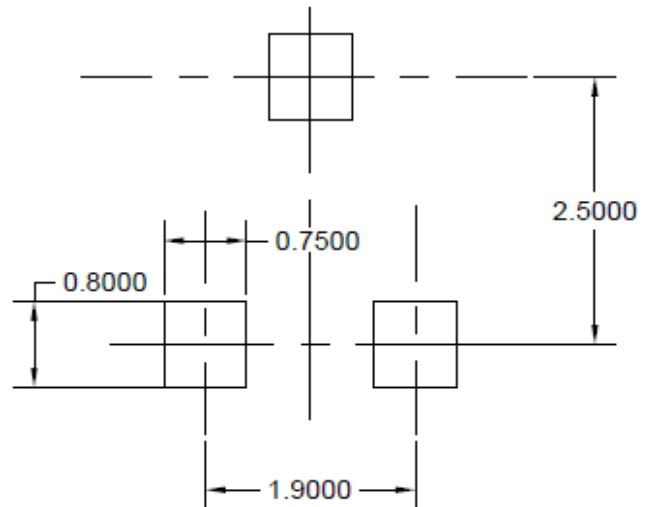

Note: Drain opening is recommended to be solder mask defined in a copper fill for improved thermal performance

Analog Power (APL) reserves the right to make changes without further notice to any products herein. APL makes no warranty, representation or guarantee regarding the suitability of its products for any particular purpose, nor does APL assume any liability arising out of the application or use of any product or circuit, and specifically disclaims any and all liability, including without limitation special, consequential or incidental damages. "Typical" parameters which may be provided in APL data sheets and/or specifications can and do vary in different applications and actual performance may vary over time. All operating parameters, including "Typicals" must be validated for each customer application by customer's technical experts. APL does not convey any license under its patent rights nor the rights of others. APL products are not designed, intended, or authorized for use as components in systems intended for surgical implant into the body, or other applications intended to support or sustain life, or for any other application in which the failure of the APL product could create a situation where personal injury or death may occur. Should Buyer purchase or use APL products for any such unintended or unauthorized application, Buyer shall indemnify and hold APL and its officers, employees, subsidiaries, affiliates, and distributors harmless against all claims, costs, damages, and expenses, and reasonable attorney fees arising out of, directly or indirectly, any claim of personal injury or death associated with such unintended or unauthorized use, even if such claim alleges that APL was negligent regarding the design or manufacture of the part. APL is an Equal Opportunity/Affirmative Action Employer.